

2

OPTIONAL ACCESSORIES

INTAKE

HOSE KIT TR P/N 810509 Standard on TR units. [8"(203mm) x 12.5' (3.8m)]

HOSE KIT HTR P/N 810896 Standard on HTR units. [10"(254mm) x 12.5' (3.8m)]

HOSE COUPLER KIT 8" (203mm) TR P/N 810525 Quick release coupler joins 2 hoses together to increase vacuuming distance and allows hoses to be separated for storage.

HOSE CONNECTOR KIT 8" (203mm) TR P/N 810524

HOSE CONNECTOR KIT 10" (254mm) HTR P/N 810776

For permanently connecting 2 hoses together to increase vacuuming distance .

EXHAUST

ALL MODELS

EXHAUST EXTENSION KIT P/N 810637 Increases exhaust height 11"(280mm) for loading debris into elevated locations.

EXHAUST HOSE KIT P/N 810508 [7"(178mm) x 12.5' (3.8m)] Quick release coupler and hose increases exhaust distance.

EXHAUST HOSE COUPLER KIT P/N 810506 [7"(178mm)] Quick release coupler joins 2 hoses together to increase vacuuming distance and allows hoses to be separated for storage.

EXHAUST HOSE CONNECTOR KIT P/N 810510 [7"(178mm)] Permanently joins 2 exhaust hoses together to increase exhaust distance.

PANEL FILTER KIT P/N 810584 Provides air filter panel for use on truck and trailer mounted debris enclosures.

PORTABLE DEBRIS BAG P/N 810660 1.3 yds.³ (0.99m³) or 29 bushels (51.35L). For portable use. Several bags can be filled and left for later pickup.

MOUNTING

ALL MODELS

TRAILER HITCH MOUNT KIT P/N 810990 Mounts Truck Loaders to any vehicle with a standard 2" square (Class 3) hitch receiver.

1

**BILLY
GOAT**
INDUSTRIES, INC.



CE 95

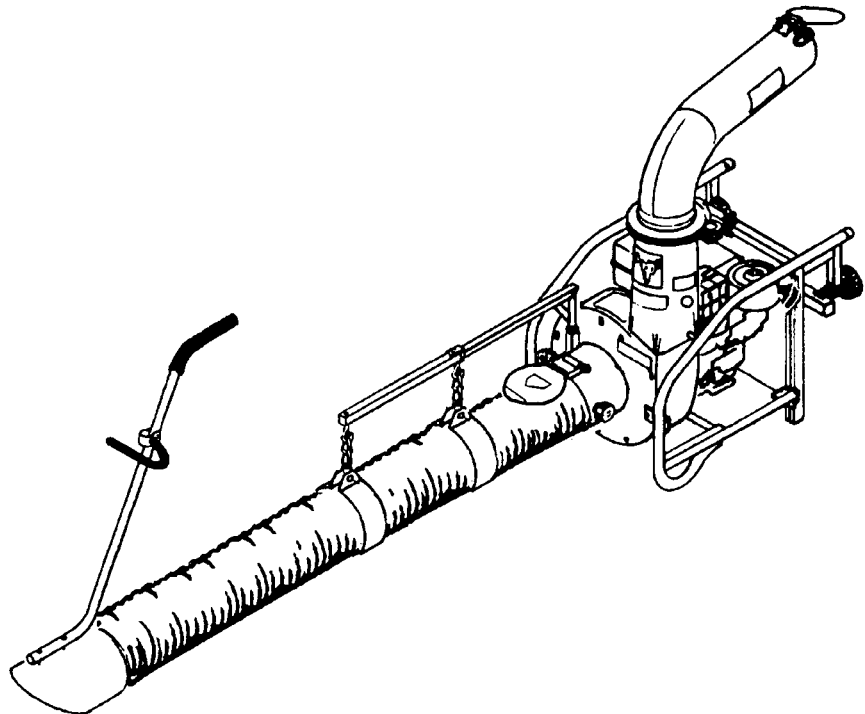

Thank You for Selecting

The Powerful TRUCK LOADER VACUUM

Operator Owner's Manual

**HTR1600VN, TR1101H,
TR1101IC, TR801IC**

3

Specifications

	HTR1600VN		TR1101H		TR1101IC		TR801IC	
ENGINE: H.P.	16 H.P. (11.93 kW) TWIN OHV VANGUARD GUARD		11.0 HP (8.2 kW)		11.0 HP (8.2 kW)		8.0 HP (5.97 kW)	
ENGINE: WEIGHT	79 lbs. (35.83 kg)		68.4 lbs. (31 kg)		64.25 lbs. (29.1 kg)		49 lbs. (22.2 kg)	
ENGINE: TYPE	Briggs & Stratton 4 Cycle I/C Twin		HONDA 4 cycle		B & S 4 cycle I/C		B & S 4 cycle I/C	
ENGINE: FUEL CAPACITY	7.2 qt. (6.8 L)		6.9 qt. (6.0 L)		6.0 qt. (5.7 L)		4.0 qt. (3.8 L)	
ENGINE: OIL CAPACITY	1.75 qt. (1.66 L), Oil pump w/filter		1.16 qt. (1.1 L)		1.5 qt. (1.42 L)		1.38 qt. (1.30 L)	
	UNIT	SHIP	UNIT	SHIP	UNIT	SHIP	UNIT	SHIP
UNIT WEIGHT:	208 lb (94.5 kg)	-----	183 lb (83 kg)	-----	179 lb (81 kg)	-----	161 lb (73 kg)	-----
NOZZLE KIT WEIGHT:	8 lb (3.6 kg)	-----	7 lb (3 kg)	-----	7 lb (3 kg)	-----	7 lb (3 kg)	-----
UNIT & NOZZLE WEIGHT:	216 lb (97.9 kg)	253 lb (114.8 kg)	190 lb (86 kg)	219 lb (99 kg)	186 lb (84 kg)	215 lb (97 kg)	168 lb (76 kg)	197 lb (89 kg)
HOSE WEIGHT:	30 lb (13.6 kg)	46 lb (20.9 kg)	26 lb (12 kg)	31 lb (14 kg)	26 lb (12 kg)	31 lb (14 kg)	26 lb (12 kg)	31 lb (14 kg)
TOTAL WEIGHT (2 cartons):	246 lb (111.7 kg)	299 lb (135.6 kg)	216 lb (98 kg)	252 lb (114 kg)	212 lb (96 kg)	248 lb (112 kg)	194 lb (88 kg)	230 lb (104 kg)

UNIT SIZE: OVERALL LENGTH: HTR 36.5"(0.93m) / TR 35"(0.89m) OVERALL WIDTH: 24.25" (0.62m) OVERALL HEIGHT: 44" (1.12m)

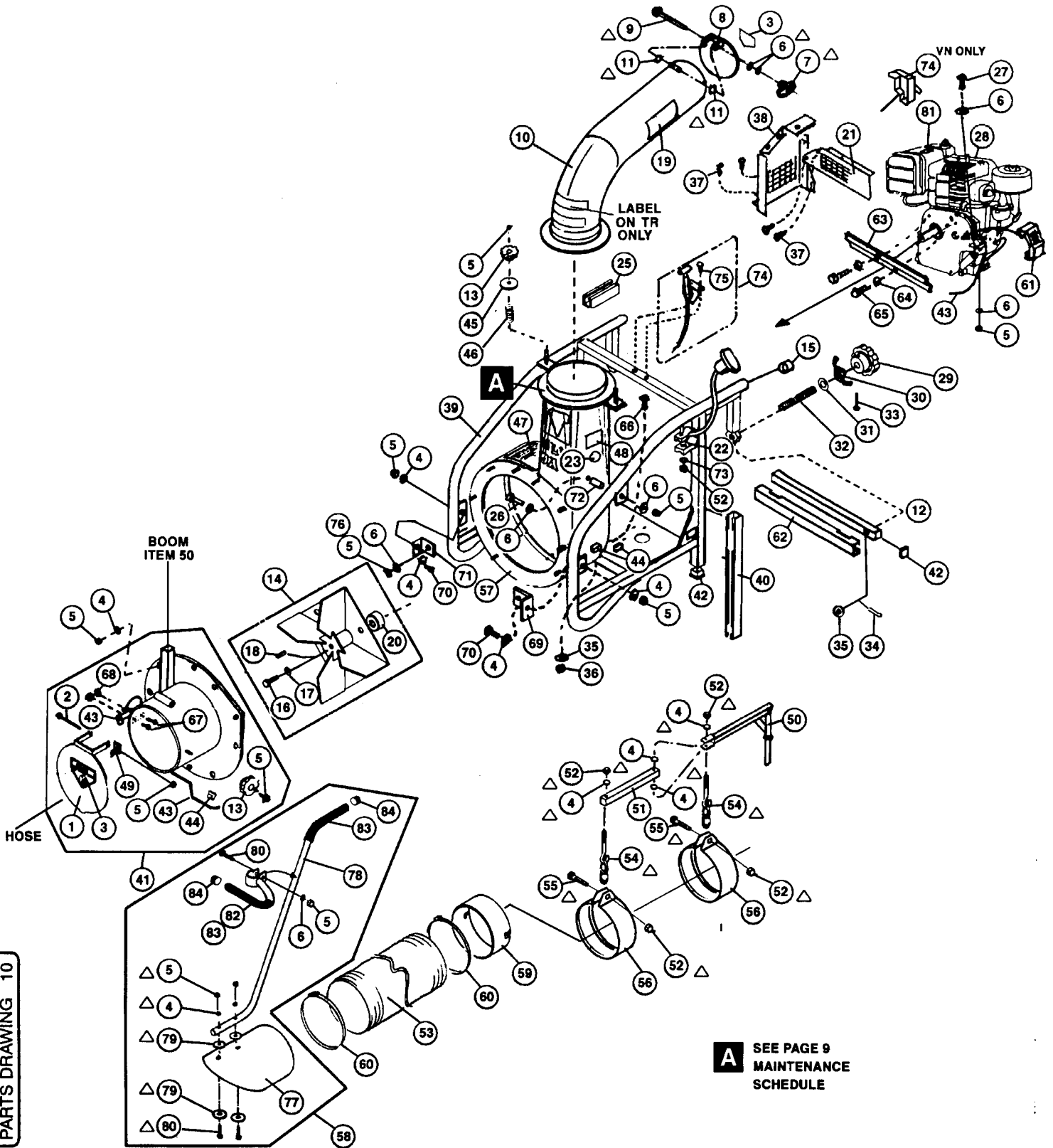

A SEE PAGE 9
MAINTENANCE
SCHEDULE



Item No.	19 PARTS LIST	Description	HTR1600VN	Qty.	TR1101H	Qty.	TR1101C	Qty.	TR801C	Qty.
			Part No.		Part No.		Part No.		Part No.	
1	FLAPPER 10" INTAKE W/LABEL	810956	1	- - -	--	- - -	--	- - -	--	- - -
	FLAPPER 8" INTAKE W/ LABEL	- - -	--	810558	1	810558	1	810558	1	810558
2	SCREW CAP 5/16-18 x 3 1/4	*8041037	1	*8041037	1	*8041037	1	*8041037	1	*8041037
3	LABEL DANGER KEEP HANDS AND FEET AWAY	400424	2	400424	2	400424	2	400424	2	400424
4	WASHER 5/16 SAE (11/32 ID x 11/16 OD x 1/16)	*8172008	19	*8172008	14	*8172008	14	*8172008	14	*8172008
5	NUT LOCK 5/16-18	*8160002	23	*8160002	18	*8160002	18	*8160002	18	*8160002
6	WASHER 5/16 FLAT CUT (3/8 I.D. x 7/8 O.D. x 1/16)	*8171003	14	*8171003	14	*8171003	10	*8171003	10	*8171003
7	KNOB (EXHAUST)	900456	1	900456	1	900456	1	900456	1	900456
8	FLAPPER 7" EXHAUST W/LABEL	810958	1	810958	1	810958	1	810958	1	810958
9	CARRIAGE BOLT 5/16-18 x 3 1/2	*8024050	1	*8024050	1	*8024050	1	*8024050	1	*8024050
10	ELBOW HTR / TR EXHAUST W/LABELS	810957	1	810957	1	810957	1	810957	1	810957
11	LOCK WASHER 5/16 EXT.	*8181008	2	*8181008	2	*8181008	2	*8181008	2	*8181008
12	TUBE CLAMP	810953	1	810953	1	810953	1	810953	1	810953
13	KNOB	400339	3	400339	3	400339	3	400339	3	400339
14	IMPELLER ASSY (INCLUDES 16(1),17(1),18(1), 20(1))	810930	1	810974	1	810629	1	810629	1	810629
15	CAP END	800392	2	800392	2	800392	2	800392	2	800392
16	SCREW CAP 3/8-24 x 2" GR 8 [50 Ft. Lbs. (68 N·m)]	810962	1	- - -	--	- - -	--	- - -	--	- - -
	SCREW CAP 3/8 - 24 X 2 1/4 GR 8 [50 Ft. Lbs. (68 N·m)]	- - -	--	810932	1	- - -	--	- - -	--	- - -
	SCREW CAP 7/16 - 20 X 1 1/4 GR 5 [60 Ft. Lbs. (81.4 N·m)]	- - -	--	- - -	--	800554	1	800554	1	800554
17	WASHER LOCK 3/8 TWISTED TOOTH	400502	1	400502	1	- - -	--	- - -	--	- - -
	WASHER LOCK 7/16 TWISTED TOOTH	- - -	--	- - -	--	850132	1	850132	1	850132
18	KEY SQ. 1/4 x 2 3/4	*9201125	1	*9201125	1	- - -	--	- - -	--	- - -
	KEY SQ. 1/4 X 2 1/4	- - -	--	- - -	--	*9201123	1	*9201123	1	*9201123
19	LABEL DANGER FLYING MATERIAL	810736	2	810736	2	810736	2	810736	2	810736
20	SPACER IMPELLER	830112	1	830112	1	- - -	--	- - -	--	- - -
21	GUARD MANIFOLD HTR	810908	1	- - -	--	- - -	--	- - -	--	- - -
22	GUIDE STARTER ROPE	830297	2	830297	2	830297	2	830297	2	830297
23	LABEL READ OWNER'S MANUAL	890301	1	890301	1	890301	1	890301	1	890301
24	PARTS BAG ASSY (INCL. 4(6), 5(3), 6(3), 7, 9, 11(2), 23, 52(4), 54(2), 55(2), 79(4), 80(2))	810935	1	810935	1	810935	1	810935	1	810935
25	PAD CHANNEL TOP HTR	810950	2	810950	2	810950	2	810950	2	810950
26	CARRIAGE BOLT 5/16-18 x 1 3/4	*8024043	1	- - -	--	- - -	--	- - -	--	- - -
	CARRIAGE BOLT 5/16-18 x 3 1/2	- - -	--	*8024050	1	*8024050	1	*8024050	1	*8024050
27	SCREW CAP 5/16-18 x 1 3/4	*8041031	4	*8041031	4	*8041031	4	*8041031	4	*8041031
28	ENGINE 16 H.P. VN	810693	1	- - -	--	- - -	--	- - -	--	- - -
	ENGINE HONDA 11HP	- - -	--	400931	1	- - -	--	- - -	--	- - -
	ENGINE BRIGGS 11 HP	- - -	--	- - -	--	400466	1	- - -	--	- - -
	ENGINE BRIGGS 8 HP	- - -	--	- - -	--	- - -	--	800880	1	800880
29	KNOB	850154	2	850154	2	850154	2	850154	2	850154
30	NUT LOCK W.A.	800227	2	800227	2	800227	2	800227	2	800227
31	WASHER 3/4, PLASTIC	800109	2	800109	2	800109	2	800109	2	800109
32	STUD 3/4 -10 x 5 1/2	810954	2	810954	2	810954	2	810954	2	810954
33	SCREW MACHINE #10-24 x 2	*8059143	2	*8059143	2	*8059143	2	*8059143	2	*8059143
34	PIN COTTER 1/8 x 1"	*8197031	2	*8197031	2	*8197031	2	*8197031	2	*8197031
35	WASHER 3/8 SAE	*8172009	4	*8172009	4	*8172009	4	*8172009	4	*8172009
36	NUT LOCK 3/8-16	*8160003	2	*8160003	2	*8160003	2	*8160003	2	*8160003
37	SCREW SHEET METAL 1/4 AB x 3/4	*8122082	4	- - -	--	- - -	--	- - -	--	- - -
38	GUARD MUFFLER KIT 16HP VN	811002	1	- - -	--	- - -	--	- - -	--	- - -
39	FRAME W.A. HTR / TR	810940	1	810940	1	810940	1	810940	1	810940
40	PAD CHANNEL 1" x 19 1/2"	810949	2	810949	2	810949	2	810949	2	810949
41	PLATE FRONT 10" HTR W/INTERLOCK (INCL. 1,2,5(2),13,43,44,49,67,68)	810919	1	- - -	--	- - -	--	- - -	--	- - -
	PLATE FRONT 8" TR W/INTERLOCK (INCL. 1,2,5(2),13,43,44,49,67,68)	- - -	--	810984	1	810975	1	810975	1	810975
42	PLUG CAP 1" SQUARE	810535	4	810535	4	810535	4	810535	4	810535
43	CABLE ASSY INTERLOCK	810922	1	810983	1	810595	1	810595	1	810595
44	CLIP-CABLE LIFT	850200	3	850200	3	850200	3	850200	3	850200
45	WASHER-EXTENSION	810652	2	810652	2	810652	2	810652	2	810652
46	SPRING	400332	2	400332	2	400332	2	400332	2	400332
47	LABEL CAUTION	830138	1	830138	1	830138	1	830138	1	830138
48	LABEL EAR,EYE,BREATHING	890254	1	890254	1	890254	1	890254	1	890254
49	BRACKET STOP FLAPPER	810941	1	810941	1	810941	1	810941	1	810941
50	BOOM-PIVOT W.A.	810870	1	810870	1	810870	1	810870	1	810870
51	TUBE-SQUARE BOOM ARM	810875	1	810875	1	810875	1	810875	1	810875
52	NUT LOCK 1/4-20	*8160001	5	*8160001	5	*8160001	5	*8160001	5	*8160001
53	HOSE 10" x 12.5' HTR (COMES IN SEPERATE BOX)	810705	1	- - -	--	- - -	--	- - -	--	- - -
	HOSE 8" x 12.5' TR (COMES IN SEPERATE BOX)	- - -	--	810523	1	810523	1	810523	1	810523
54	CHAIN-LOOP ASSY	810878	2	810878	2	810878	2	810878	2	810878
55	SCREW CAP 1/4-20 x 1 3/4	*8041009	2	*8041009	2	*8041009	2	*8041009	2	*8041009
56	BAND HOSE BOOM 10" HTR	810868	2	- - -	--	- - -	--	- - -	--	- - -
	BAND HOSE BOOM 8" TR	- - -	--	810880	2	810880	2	810880	2	810880
57	HOUSING ASSY W/LABELS (INCLUDES 5(2), 13(2), 45(2), 46(2), 47, 48)	810912	1	810976	1	810976	1	810976	1	810976
58	NOZZLE ASSY 10" HTR (INCL. 4(2), 5(3), 6, 23, 77, 79(4), 80(2), 82, 83, 84)	811010	1	- - -	--	- - -	--	- - -	--	- - -
	NOZZLE ASSY 8" TR (INCL. 4(2), 5(3), 6, 23, 77, 79(4), 80(2), 82, 83, 84)	- - -	--	811009	1	811009	1	811009	1	811009
59	COUPLER W.A. 10" HOSE HTR	810761	1	- - -	--	- - -	--	- - -	--	- - -
	COUPLER W.A. 8" TR	- - -	--	810570	1	810570	1	810570	1	810570
60	CLAMP HOSE 10" HTR	810706	2	- - -	--	- - -	--	- - -	--	- - -
	CLAMP HOSE 8" TR	- - -	--	810566	2	810566	2	810566	2	810566
61	GUARD EXHAUST LEFT	400682	1	- - -	--	- - -	--	- - -	--	- - -
62	PAD CHANNEL CLAMP TUBE	810952	1	810952	1	810952	1	810952	1	810952
63	SUPPORT PLATE ENGINE / SPACER ENG.	810927	1	810965	1	- - -	--	- - -	--	- - -

* Denotes standard
hardware item that may
be purchased locally.△ Denotes parts found
in parts bag assembly.

Item No.	19 PARTS LIST	Description	HTR1600VN	Qty.	TR1101H	Qty.	TR1101C	Qty.	TR801C	Qty.
			Part No.		Part No.		Part No.		Part No.	
64		WASHER LOCK 3/8	*8177012	2	*8177012	2	- - -	-	*8177012	2
		WASHER LOCK 5/16 EXT. TOOTH	- - -	-	- - -	-	*8181008	2	- - -	-
65		SCREW CAP 3/8 - 16 X 3/4	*8041048	2	- - -	-	- - -	-	*8041048	2
		SCREW CAP 3/8 - 16 X 1 1/2 GR8	- - -	-	810980	2	- - -	-	- - -	-
		SCREW CAP 5/16 - 24 X 3/4 G5	- - -	-	- - -	-	*8042026	2	- - -	-
66		SCREW CAP 3/8 - 16 x 1"	*8041050	2	*8041050	2	*8041050	2	*8041050	2
67		SCREW MACHINE #6-32 x 3/4	*8059094	2	*8059094	2	*8059094	2	*8059094	2
68		NUT LOCK #6 - 32	*8164003	2	*8164003	2	*8064003	2	*8044003	2
69		ANGLE BRKT R.H.	810917	1	- - -	-	- - -	-	- - -	-
70		SCREW CAP 5/16-18 x 1"	*8041028	2	*8041028	1	*8041028	1	*8041028	1
71		ANGLE BRKT L.H.	810916	1	810969	1	810969	1	810969	1
72		SPACER	810918	1	810970	1	810970	1	810970	1
73		WASHER FLAT CUT 1/4	*8171002	1	*8171002	1	*8171002	1	*8171002	1
74		CONTROL THROTTLE ASSY	810904	1	810972	1	810657	1	810657	1
75		SCREW MACHINE 10-24 x 1/2"	- - -	-	*8123086	2	*8123086	2	*8123086	2
76		NUT LOCK 5/16-18 THIN HT.	- - -	-	8161041	1	8161041	1	8161041	1
77		NOZZLE FORMED STEEL 10"	811005	1	- - -	-	- - -	-	- - -	-
		NOZZLE FORMED STEEL 8"	- - -	-	811007	1	811007	1	811007	1
78		HANDLE NOZZLE W / GRIP	811020	1	811020	1	811020	1	811020	1
79		WASHER FENDER 5/16	*8172020	4	*8172020	4	*8172020	4	*8172020	4
80		SCREW CAP 5 /16 - 18 X 1 1/2	*8041030	3	*8041030	3	*8041030	3	*8041030	3
81		LABEL DO NOT FILL WHEN ENGINE IS HOT	400268	1	400268	1	400268	1	400268	1
82		HANDLE LOOP NOZZLE	811019	1	811019	1	811019	1	811019	1
83		GRIP HANDLE	400570	1	400570	1	400570	1	400570	1
84		PLUG CAP	800392	2	800392	2	800392	2	800392	2